

DLHCV OSCILLATOR



Specifications

Parameters	Standard	Options	
Frequency range	0,500 MHz - 200,000 MHz		
Logic output	HCMOS/TTL compatible	TTL only	
Frequency stability			
Overall	+ 50,0 ppm	+ -15,0 ppm best possible	
Initial at 25°C	Please specify		
Temperature			
vs supply voltage change			
vs load change			
Aging first year			
Aging over Years			
Operating temperature	0° C ~ +70°C	-20°C ~ +70°C	
		-40°C ~ +85°C	
		Other on custom request	
Storage temperature	-40°C ~ +85°C	-55°C ~ +125°C	
Supply voltage	5,0 V ± 5% or 3,3 V +-5%	Other on custom request	
Current	10 - 80 mA max	Other	
Load	15 pF	Other - dependent of logic output	
Rise/fall time	Other on custom request		
0,500 MHz - 7,999 MHz			8 ns max.
8,000 MHz - 79,999 MHz			6 ns max.
80,000 MHz -200,000 MHz			4 ns max.
Duty cycle	40/60 %	45/55 %	
		Other on custom request	
Phase noise	Please specify (if required)		
Harmonics			
Sub-harmonics			
Jitter			
Start-up time	10 ms max.	Other on custom request	
Frequency trimming range with externally adjustable trimmer	± 3 ppm min.		
	Other		

DLHCV OSCILLATOR

Specifications

Parameters	Standard	Options
Linearity	± 10% max.	Other on custom request
Frequency tuning range	± 50 ppm - ± 200 ppm min	Other on custom request
Pulling slope	Positive	Other on custom request
External control voltage	+ 1,65 VDC ±1,65 VDC (3,3V) +2,5 VDC ±2,5 VDC (5,0V)	Other
Marking	Freq + Code + Week +Year	
Package	DIL08 DIL08-7 DIL08-9	

Drawing

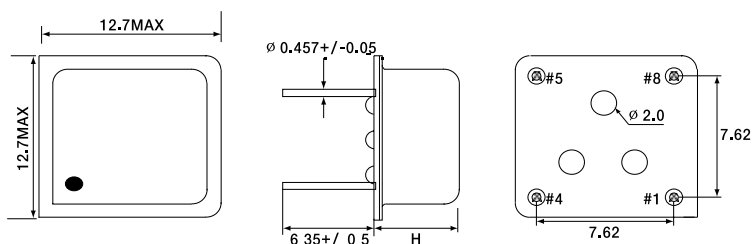

Case	H
DIL08	5.08
DIL08-7	7.48
DIL08-9	9.0

Pin configuration	#1: Control voltage	other pin configuration possible
	#4 : GND	
	#5 : Output	
	#8 : Vcc	